

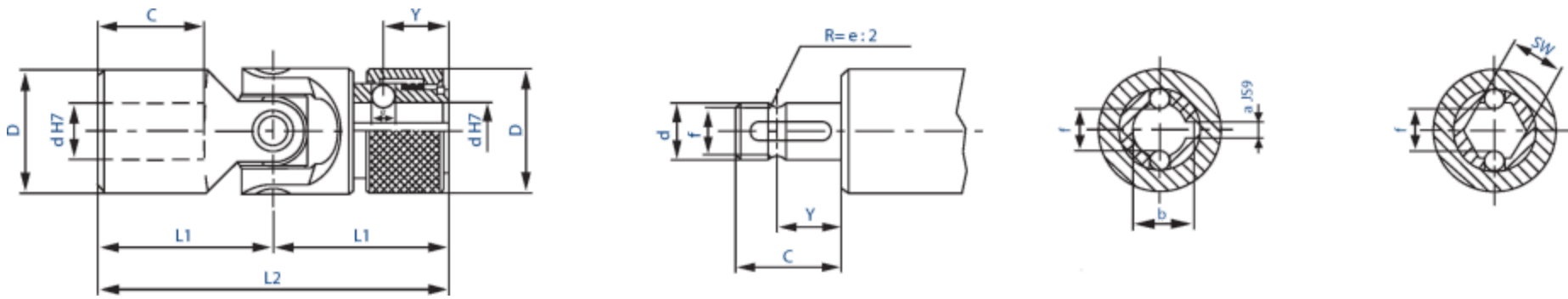

# Universal joints with quick release

## Specifications:

- Type GR; universal joints with plain bearing
- Type HR; universal joints with needle bearing
- Type GR; Suitable up to a max. speed of 1000 (1/min)
- Type HR; Suitable up to a max. speed of 4000 (1/min)
- Maximum articulation angle 45°
- According to DIN 808
- Available with finish bore H7 with keyway to DIN 6885-1 (JS9) or with square bore



## Universal joints with quick release to DIN 808

Type		Dimensions										
Plain bearing	Needle bearing	d (H7)	D	L1	L2	C	Y	e	F	a (JS9)	b	SW (H8)
02GR	-	8	16	26	52	14	9,5	3,5	6,3	2	9	8
03GR	03HR	10	22	31	62	17	11,5	4,0	8,7	3	11	10
04GR	04HR	12	25	37	74	21	13,5	4,0	11,0	4	13,3	12
05GR	05HR	14	25	37	74	21	13,5	4,0	13,0	5	15,3	14
1GR	1HR	16	32	43	86	24	14	6,35	14,8	5	17,3	16
2GR	2HR	18	36	48	96	28	19	8,0	16,0	6	19,8	18
3GR	3HR	20	42	54	108	31	19	8,0	18,0	6	22,8	20
4GR	4HR	22	45	60	120	34	20,5	10,0	20,0	6	24,8	22
5GR	5HR	25	50	66	132	38	20,5	10,0	23,0	8	28,3	25
6GR	6HR	30	58	83	166	49	25	10,0	28,0	8	33,3	30